



FOOTWAY/CYCLEWAY TO CONNECT WITH
PROPOSED UNCONTROLLED CROSSING
BEING PROVIDED AS PART OF THE COBDENS
DEVELOPMENT (SHOWN INDICATIVELY).
ROAD MARKINGS AND TACTILE PAVINGS TO
BE AMENDED AS REQUIRED.

ROAD MARKING PROPOSED AS PART OF THE
COBDENS DEVELOPMENT (SHOWN
INDICATIVELY) TO BE AMENDED AS REQUIRED

2.4m x 43m VISIBILITY SPLAY

2.4m x 43m VISIBILITY SPLAY

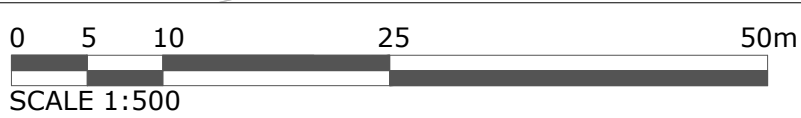
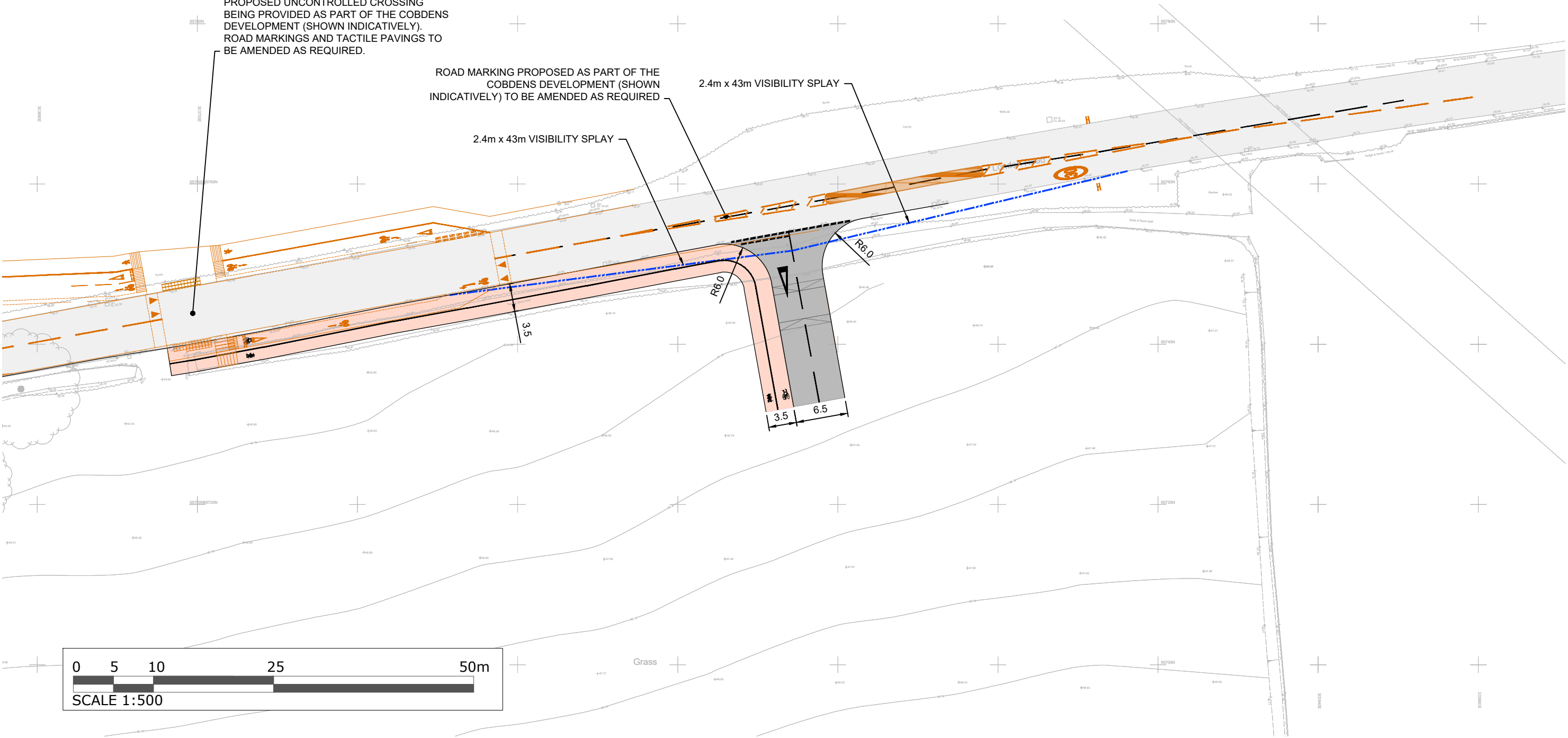

REV	DETAILS	DRAWN	CHECKED	DATE	NOTES:	KEY	PROJECT:	CLIENT:
A	Footways / Cycleways changed to 3.5m wide. Accesses changed to 6.5m wide	BJC	RJW	09.02.2024	1. Do not scale from this drawing.	Existing Carriageway	Grange Expansion Area, Cranbrook	Baker Estates
B	Footways / Cycleways along site frontage removed. Proposed pedestrian crossing on London Road shown.	BJC	RJW	26.03.2024	2. This drawing is for illustrative purposes only and not for construction.	Existing Footway / Cycleway	DRAWING TITLE:	
C	Eastern FW/CW removed and associated crossing. Proposed Cobdens FW/CW arrangement shown indicatively.	BJC	RJW	17.05.2024	3. This drawing is to be read and printed in colour.	Verge	Junction 4	
D	Access moved west to be adjacent to the proposed attenuation pond.	BJC	RJW	31.05.2024	4. All dimensions are shown in metres, unless specified otherwise.	Proposed Carriageway	Eastern Residential	
E	Attenuation pond removed.	SLW	RJW	01.07.2024		Proposed Footway / Cycleway	Access Arrangement	
						Proposed Footway / Cycleway (Provided by Others)	DRAWN: BJC	
							CHECKED: RJW	
							DATE: 06.02.2024	
							SCALES: 1:500	
							SHEET SIZE: A3	
							DRAWING NUMBER: 19022-SK-04	
							REVISION: E	

NOTE: THE PROPERTY OF THIS DRAWING AND DESIGN IS VESTED IN MILES WHITE TRANSPORT LTD. IT MUST NOT BE COPIED OR REPRODUCED IN ANY WAY WITHOUT THEIR PRIOR WRITTEN CONSENT.